

■ PACKAGE DIMENSIONS :

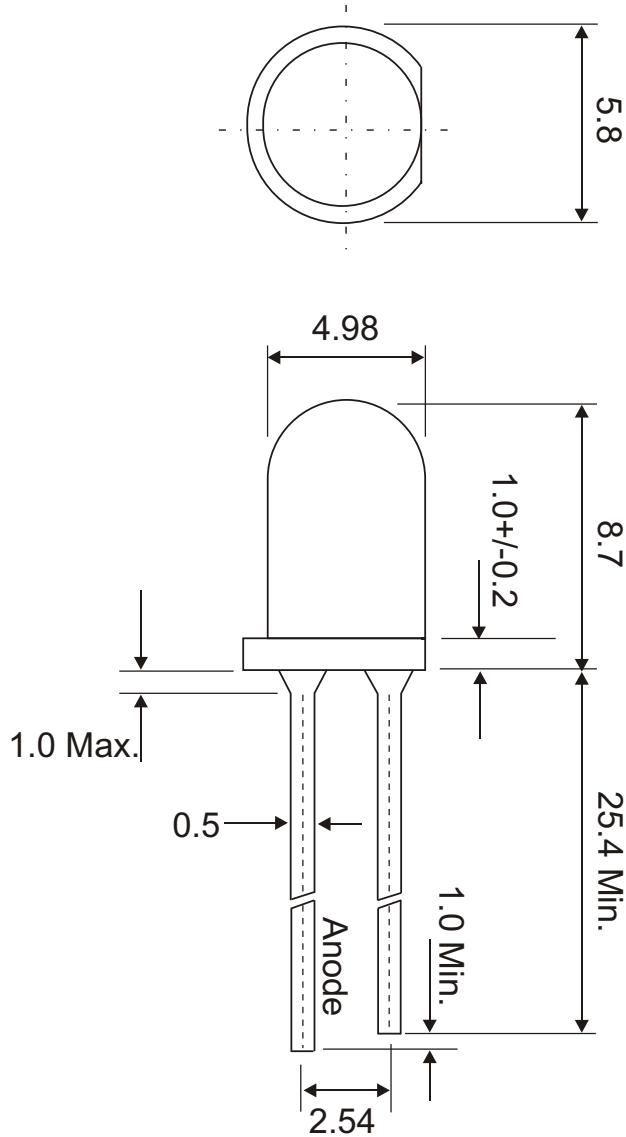

Chips Material	Emitting Color	Lens Shape	Lens Color
AlGaInP	Red	5mm Round	Red Diffused

Notes :

1. Lead spacing is measured where the leads emerge from the package
2. Protruded resin under flange 1.5mm(0.059") Max.
3. All dimensions are in millimeters, Tolerance is 0.25mm unless otherwise noted.



Electro-Optical Characteristics (Ta=25°C)

Parameter	Symbol	Min.	Typ.	Max.	Unit	Test Condition
Luminous Intensity	I _v	See Page 4 for our * Ranking System*			mcd	I _F = 20 mA
Viewing Angle *	2θ 1/2		60		deg.	I _F = 20 mA
Peak Emission Wavelength	λ P	See Page 4 for our * Ranking System*			nm	I _F = 20 mA
Spectrum Radiation Bandwidth	Δλ		23		nm	I _F = 20 mA
Forwards Voltage	V _F	See Page 4 for our * Ranking System*			V	I _F = 20 mA
Recommended Working Current		10		20	mA	

* θ1/2 is the off-axis angle where the luminous intensity is 1/2 the peak intensity.

Absolute Maximum Ratings (Ta=25°C)

Characteristic	Symbol	Ratings	Unit
Power Dissipation	P _D	100	mW
Forward Current	I _F	30	mA
Peak Forward Current #	I _{PF}	100	mA
Reverse Voltage	V _R	5	V
Reverse Current	I _R	50	μA
Operation Temperature Range	T _{opr}	-30 ~ + 80	°C
Storage Temperature Range	T _{stg}	-40 ~ + 100	°C
Soldering Temperature Range *	T _{sol}	250°C for 3 seconds (max.)	

Duty ratio = 1/16 , Pulse width = 0.1ms

* Lead soldering temperature range (1.6mm from Body)

■ Typical Electro-Optical Characteristics Curves

Forward Current vs Forward Voltage

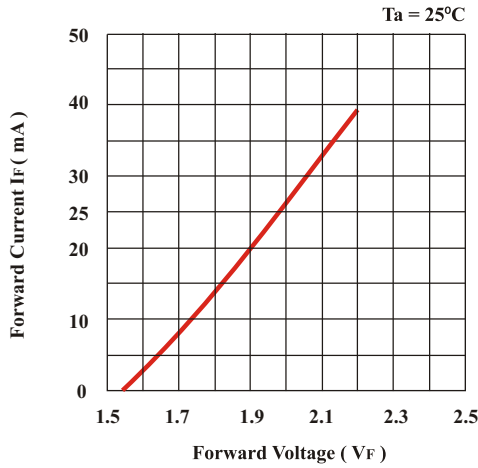

Forward Current Derating Curve

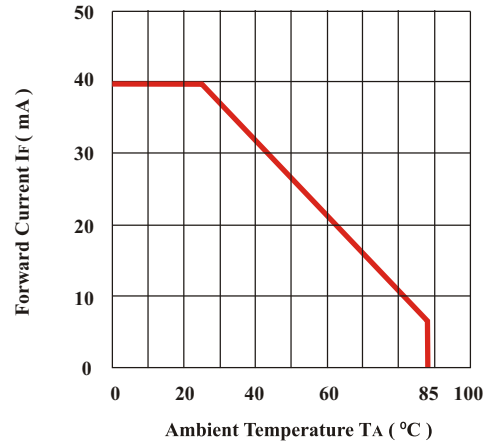

Luminous Intensity vs Ambient Temperature

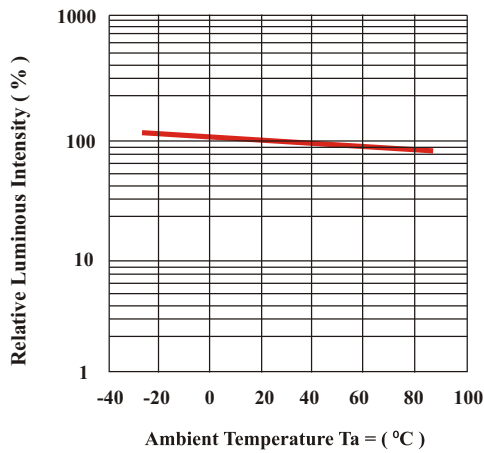

Luminous Intensity vs Forward Current

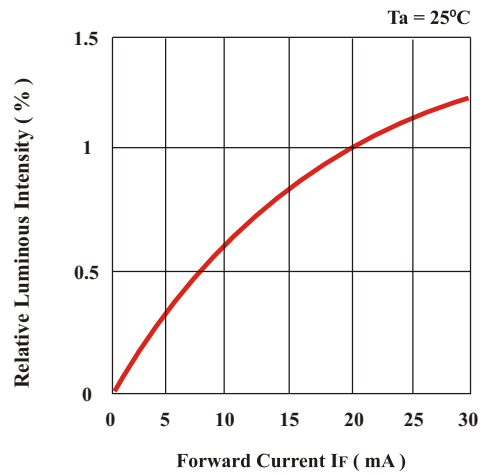

Spectrum Distribution

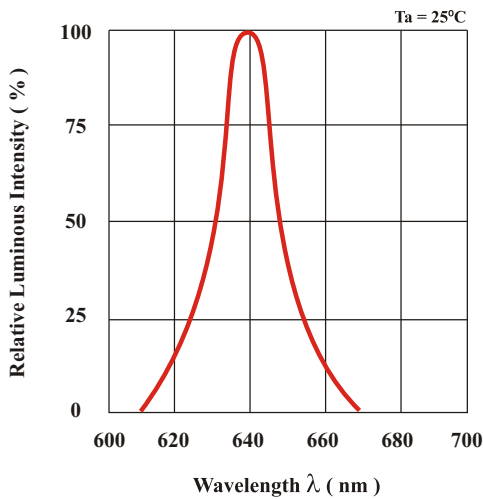

Radiation Diagram

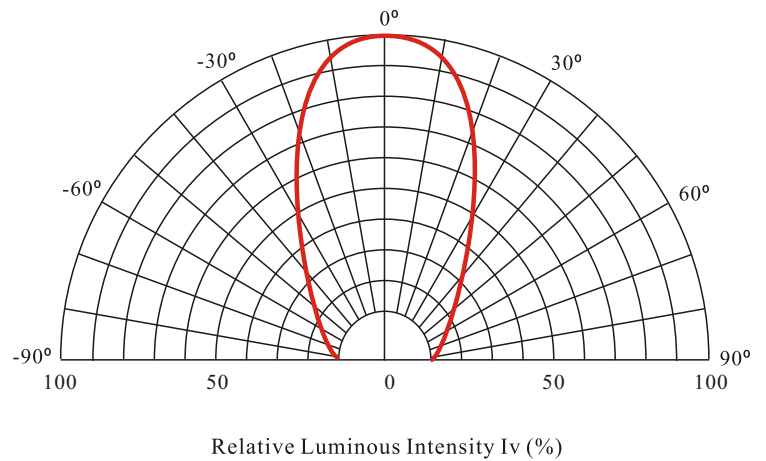

■ Ranking System (Ta = 25°C , If = 20mA)

▶ Peak Wavelength

Rank Code	Range in (nm)
1	615 ~ 620
2	620 ~ 625
3	625 ~ 630
4	630 ~ 640
5	640 ~ 660

▶ Luminous Intensity (Iv)

Rank Code	Range in (mcd)
A1	10 ~ 20
A2	20 ~ 30
A3	30 ~ 50
A4	50 ~ 100
A5	100 ~ 200

Rank Code	Range in (mcd)
A6	200 ~ 350
A7	350 ~ 500
A8	500 ~ 800
A9	800 ~ 1000
A10	1000 ~ 1400

▶ Forward Voltage (Vf) with 0.1V in Difference

Rank Code	Range in (V)
11	1.7 ~ 1.8
12	1.8 ~ 1.9
13	1.9 ~ 2.0
14	2.0 ~ 2.1
15	2.1 ~ 2.2
16	2.2 ~ 2.3

Rank Code	Range in (V)
17	2.3 ~ 2.4

Notes :

- 1 . The above data is adjustable. For further information please feel free to contact our Eng. Dept
- 2 . The tolerance for the wavelength is +/- 1 nm
- 3 . The tolerance for the forward current is +/- 0.1V
- 4 . The tolerance for the luminous intensity is +/- 15%