

■ PACKAGE DIMENSIONS :

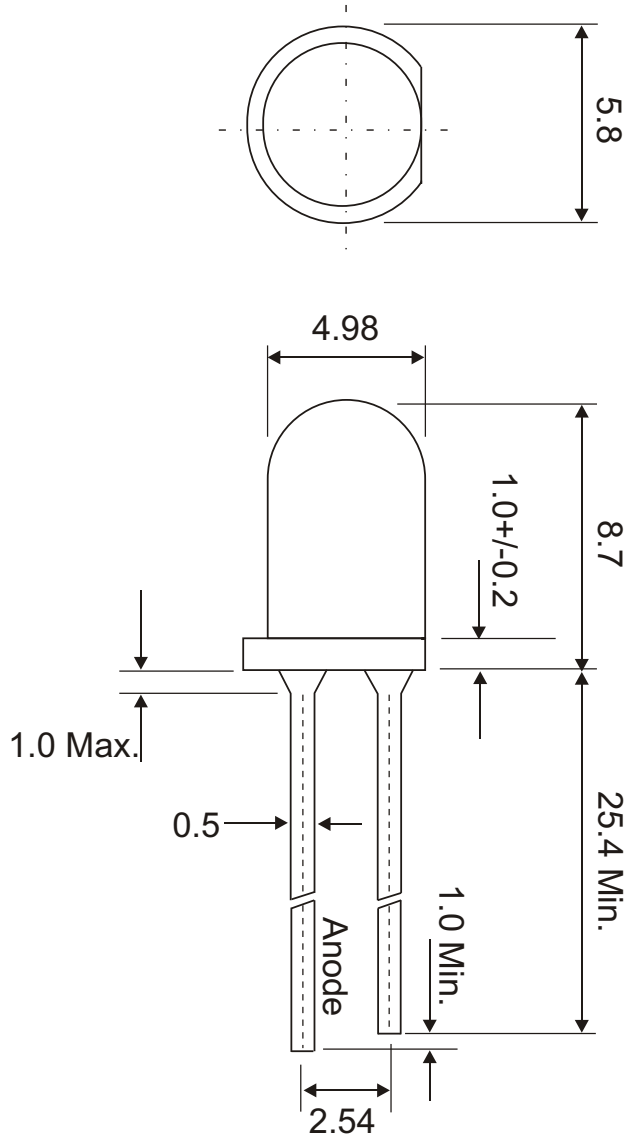

Chips Material	Emitting Color	Lens Shape	Lens Color
AlGaInP	Yellow Green	5mm Round	Water Clear

Notes :

1. Lead spacing is measured where the leads emerge from the package
2. Protruded resin under flange 1.5mm( 0.059" ) Max.
3. All dimensions are in millimeters, Tolerance is 0.25mm unless otherwise noted.



## ■ Electro-Optical Characteristics ( Ta=25°C )

Parameter	Symbol	Min.	Typ.	Max.	Unit	Test Condition
Luminous Intensity	I <sub>v</sub>	See Page 4 for our * Ranking System*			mcd	I <sub>F</sub> = 20 mA
Viewing Angle *	2θ 1/2		20		deg.	I <sub>F</sub> = 20 mA
Peak Emission Wavelength	λ <sub>P</sub>	See Page 4 for our * Ranking System*			nm	I <sub>F</sub> = 20 mA
Spectrum Radiation Bandwidth	Δλ		21		nm	I <sub>F</sub> = 20 mA
Forwards Voltage	V <sub>F</sub>	See Page 4 for our * Ranking System*			V	I <sub>F</sub> = 20 mA
Recommended Working Current		10		20	mA	

\* θ1/2 is the off-axis angle where the luminous intensity is 1/2 the peak intensity.

## ■ Absolute Maximum Ratings ( Ta=25°C )

Characteristic	Symbol	Ratings	Unit
Power Dissipation	P <sub>D</sub>	100	mW
Forward Current	I <sub>F</sub>	30	mA
Peak Forward Current #	I <sub>PF</sub>	100	mA
Reverse Voltage	V <sub>R</sub>	5	V
Reverse Current	I <sub>R</sub>	50	μA
Operation Temperature Range	T <sub>opr</sub>	-30 ~ + 80	°C
Storage Temperature Range	T <sub>stg</sub>	-40 ~ + 100	°C
Soldering Temperature Range *	T <sub>sol</sub>	250°C for 3 seconds ( max. )	

# Duty ratio = 1/16 , Pulse width = 0.1ms

\* Lead soldering temperature range ( 1.6mm from Body )

■ Typical Electro-Optical Characteristics Curves

Forward Current vs Forward Voltage

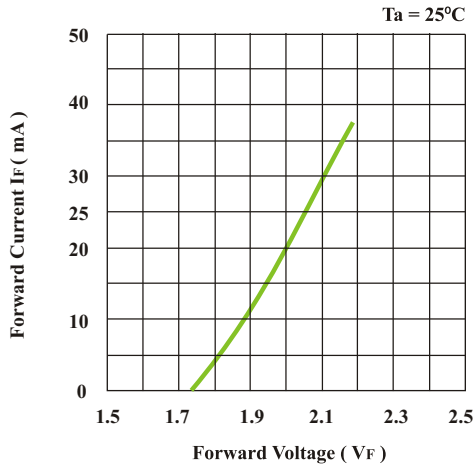

Forward Current Derating Curve

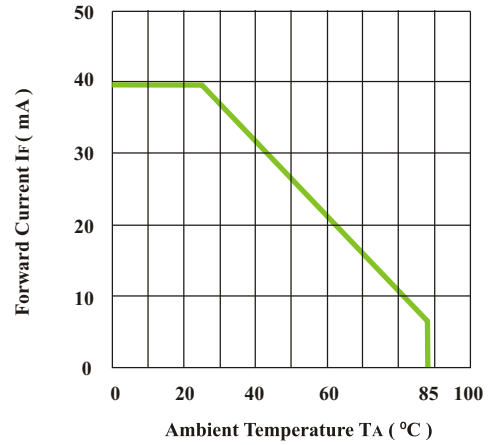

Luminous Intensity vs Ambient Temperature

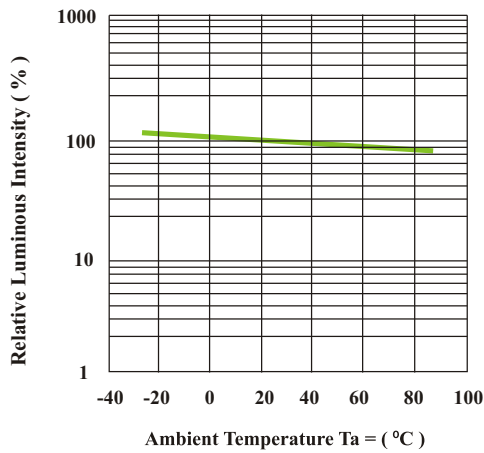

Luminous Intensity vs Forward Current

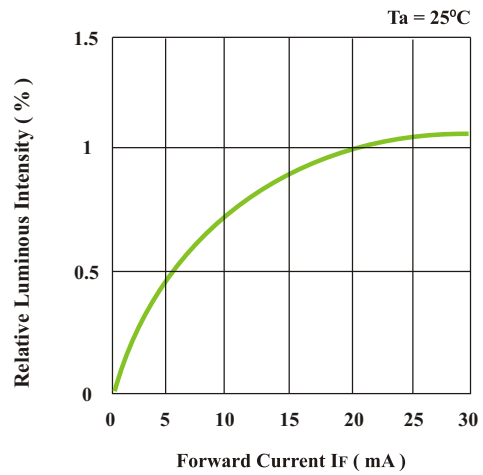

Spectrum Distribution

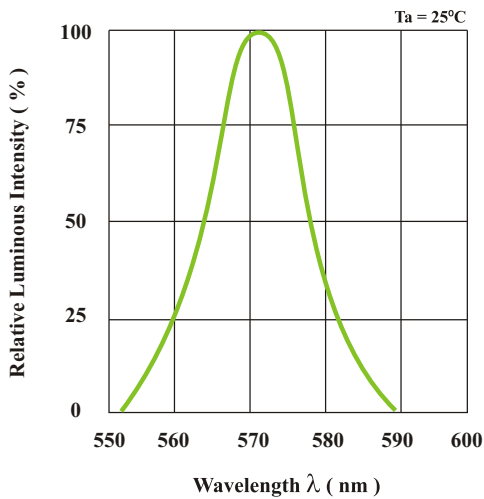

Radiation Diagram

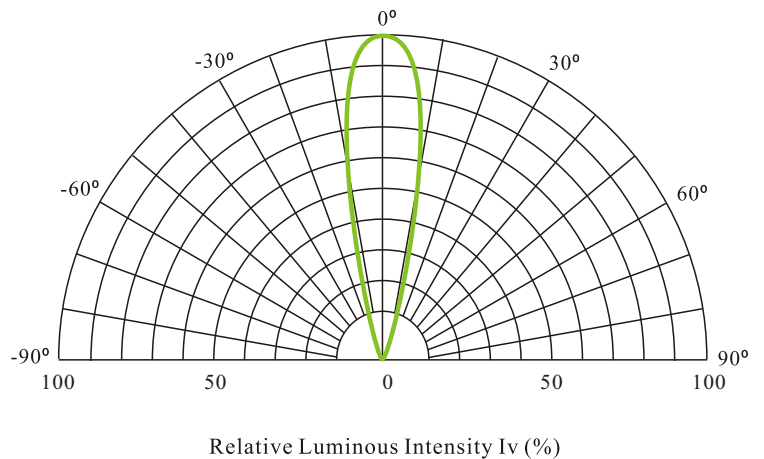

**Ranking System ( Ta = 25°C , If = 20mA )**

► **Peak Wavelength**

Rank Code	Range in ( nm )
1	563 ~ 566
2	566 ~ 569
3	569 ~ 572
4	572 ~ 575

► **Luminous Intensity ( Iv )**

Rank Code	Range in ( mcd )
A1	300 ~ 500
A2	500 ~ 800
A3	800 ~ 1000
A4	1000 ~ 1400
A5	1400 ~ 2000

Rank Code	Range in ( mcd )
A6	2000 ~ 3000
A7	3000 ~ 4000
A8	4000 ~ 6000
A9	6000 ~ 8000
A10	8000 ~ 11000

► **Forward Voltage ( Vf ) with 0.1V in Difference**

Rank Code	Range in ( V )
11	1.7 ~ 1.8
12	1.8 ~ 1.9
13	1.9 ~ 2.0
14	2.0 ~ 2.1
15	2.1 ~ 2.2
16	2.2 ~ 2.3

Rank Code	Range in ( V )
17	2.3 ~ 2.4

**Notes :**

- 1 . The above data is adjustable. For further information please feel free to contact our Eng. Dept
- 2 . The tolerance for the wavelength is +/- 1 nm
- 3 . The tolerance for the forward current is +/- 0.1V
- 4 . The tolerance for the luminous intensity is +/- 15%