

3.00mm(.118") Wire To Wire And Wire To Board Connector



SPECIFICATIONS:

- Current Rating:5A AC,DC
- Voltage Rating:250V AC,DC
- Contact Resistance:10mΩ max.
- Withstanding Voltage:1500V AC/minute

Terminal

- Wire size:AWG#20~#24
- Material:Phosphor bronze
- Finish:Tin Plated
- Thickness:0.20mm
- Qty/Reel:10000pcs
- Terminal In Housing Retention Force Requirement:2.5kg (Min.)

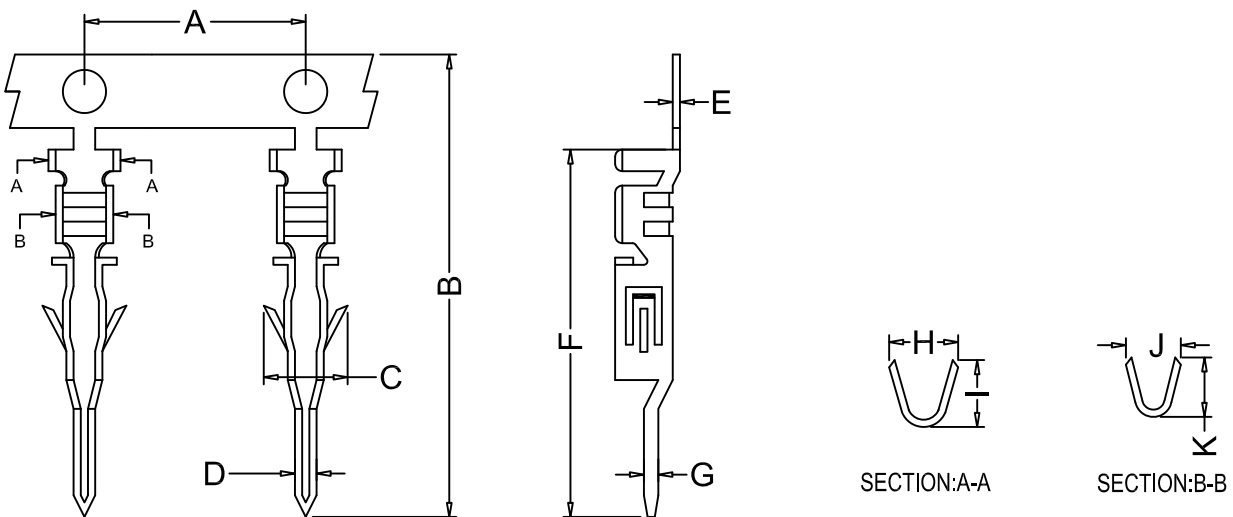
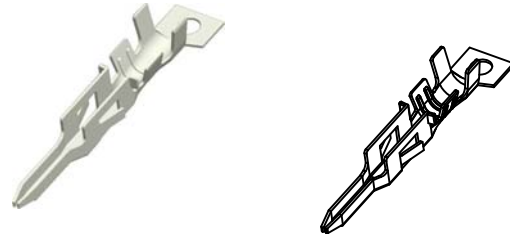

Ordering Information And Dimensions

Part NO.	A	B	C	D	E	F	G	H	I	J	K	Applicable wire	Plated
T3020PS-2	6.40	16.50	2.50	0.65	0.20	12.80	0.60	2.50	2.40	2.00	2.00	AWG#20~24	Tin-plated
T3020PS-2B	6.40	16.50	2.50	0.65	0.20	12.80	0.60	2.00	1.90	1.54	1.20	AWG#26~30	Tin-plated
T3020PS-00	6.40	16.50	2.50	0.65	0.20	12.80	0.60	2.50	2.40	2.00	2.00	AWG#20~24	Gold-plated
T3020PS-00B	6.40	16.50	2.50	0.65	0.20	12.80	0.60	2.00	1.90	1.54	1.20	AWG#26~30	Gold-plated

