

SPECIFICATIONS

CONTACT RATING: Q: 3A @120 VAC or 28 VDC (Q: terminal option)
 ELECTRICAL LIFE: 30,000 make-and-break cycles at full load
 CONTACT RESISTANCE: 20 mΩ max. initial @2-4 VDC, 100 mA
 INSULATION RESISTANCE: 1,000 MΩ min.
 DIELECTRIC STRENGTH: 1,500 V RMS @ sea level.
 OPERATING TEMPERATURE: -30°C to +85°C

MATERIALS

CASE - diallyl phthalate (DAP)(UL94V-0)
 ACTUATOR- Nylon , black standard
 BUSHING - Copper alloy , nickel plated
 HOUSING - Stainless Steel
 CONTACT AND TERMINAL - Copper alloy, silver plated
 SWITCH SUPPORT - Copper alloy , tin-plated

How do you build the switches you need!!

The RS-4 / RS-5 , please see the (A) ;

The RS-6/RS-7/RS-8/RS-9, please see the (B)

(A) R S - 4 - R 1 - 2 - C Q - E - A 5 S -

| Switches Function | | Actuator | | Actuator Color | | Termination | | Epoxy seal | | RoHS code | |
|-------------------|------------------|----------|------------|---|------------|------------------|------------------|--------------------------|---------------|--------------------|--|
| RS-4 | SP on-none-on | R1 | 7.62 width | 1 | white | B | solder lug | (none) | none seal | H = RoHS Compliant | |
| RS-4B | SP on-none-(on) | R2 | 5.84 width | 2 | Black | C | P.C | E | epoxy seal | | |
| RS-4A | SP on-off-on | R3 | 5.76 width | 3 | Red | D | wire wrap | | | | |
| RS-4H | SP (on)-off-(on) | | | The other color is available for special inquires | | | | | | | |
| RS-4I | SP on-off-(on) | | | | | | | | | | |
| RS-5 | DP on-none-on | | | | | | | | | | |
| RS-5B | DP on-none-(on) | | | | | | | | | | |
| RS-5A | DP on-off-on | | | | | | | | | | |
| RS-5H | DP (on)-off-(on) | | | | | | | | | | |
| RS-5I | DP on-off-(on) | | | | | | | | | | |
| RS-5C | DP on-on-on | | | | | | | | | | |
| | | | | Marking | | | | | | | |
| | | | | (none) | No marking | | | | | | |
| | | | | 1 | | | | | | | |
| | | | | 2 | | | | | | | |
| | | | | 3 | | | | | | | |
| | | | | 4 | | | | | | | |
| | | | | 5 | | | | | | | |
| | | | | | | Contact Material | | | | | |
| | | | | | | Q | silver plated | | | | |
| | | | | | | R | gold plated | | | | |
| | | | | | | G | gold over silver | | | | |
| | | | | | | K | gold / tin | | | | |
| | | | | | | | | Vertical support Bracket | | | |
| | | | | | | | | (none) | straight type | | |
| | | | | | | | | A5 | std. straight | | |
| | | | | | | | | A5S | snap-in type | | |

(B) R S - 6 - R 2 - 2 - Q - E - S -

| Horizon Right Angle | Vertical Right Angle | Switches Function | Actuator | | Contact Material | | Epoxy seal | | RoHS code | | |
|---------------------|----------------------|-------------------|----------|---|------------------|------------------|------------|-----------------|--------------------|--|--|
| RS-6 | RS-8 | SP on-none-on | R1 | 7.62 width | Q | silver plated | (none) | none seal | H = RoHS Compliant | | |
| RS-6B | RS-8B | SP on-none-(on) | R2 | 5.84 width | R | gold plated | E | epoxy seal | | | |
| RS-6A | RS-8A | SP on-off-on | R3 | 5.76 width | G | gold over silver | | | | | |
| RS-6H | RS-8H | SP (on)-off-(on) | | | | | | | | | |
| RS-6I | RS-8I | SP on-off-(on) | | | | | | | | | |
| RS-7 | RS-9 | DP on-none-on | | | | | | | | | |
| RS-7B | RS-9B | DP on-none-(on) | | | | | | | | | |
| RS-7A | RS-9A | DP on-off-on | | | | | | | | | |
| RS-7H | RS-9H | DP (on)-off-(on) | | | | | | | | | |
| RS-7I | RS-9I | DP on-off-(on) | | | | | | | | | |
| RS-7C | RS-9C | DP on-on-on | | | | | | | | | |
| | | | | Actuator Color | | | | | | | |
| | | | | 1 | white | | | | | | |
| | | | | 2 | Black | | | | | | |
| | | | | 3 | Red | | | | | | |
| | | | | The other color is available for special inquires | | | | | | | |
| | | | | Marking | | | | | | | |
| | | | | (none) | No marking | | | | | | |
| | | | | 1 | | | | | | | |
| | | | | 2 | | | | | | | |
| | | | | 3 | | | | | | | |
| | | | | 4 | | | | | | | |
| | | | | 5 | | | | | | | |
| | | | | | | | | Support Bracket | | | |
| | | | | | | | | (none) | std. straight | | |
| | | | | | | | | S | snap-in type | | |



TS40-R

Sub-Miniature Rocker Switches



SPDT

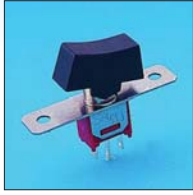

| Model No. | Switching position | | |
|-------------|--------------------|------|------|
| | | | |
| RS-4 | ON | none | ON |
| RS-4A | ON | OFF | ON |
| RS-4B | ON | None | (ON) |
| RS-4H | (ON) | OFF | (ON) |
| RS-4I | ON | OFF | (ON) |
| Term. Comm. | 2-3 | open | 2-1 |

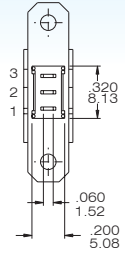
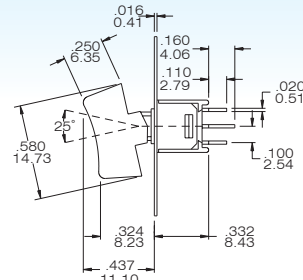
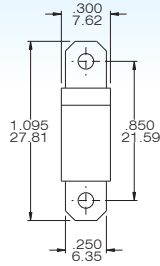

RS-4 - R1-2-BQ



DPDT



| Model No. | Switching position | | |
|-----------------------|--------------------|---------|---------|
| | | | |
| RS-5 | ON | none | ON |
| RS-5A | ON | OFF | ON |
| RS-5B | ON | None | (ON) |
| RS-5H | (ON) | OFF | (ON) |
| RS-5I | ON | OFF | (ON) |
| Term. Comm. | 2-3,5-6 | open | 2-1,5-4 |
| 3 way switches (SP3T) | | | |
| RS-5C | ON | ON | ON |
| Term. Comm. | 2-3,5-6 | 2-3,5-4 | 2-1,5-4 |

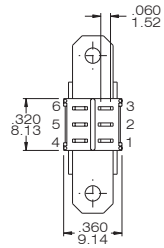
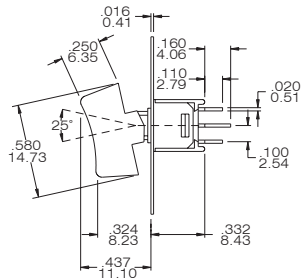
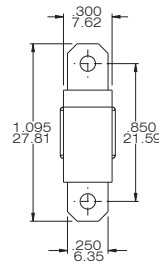

RS-5 - R1-2-BQ



SPDT



| Model No. | Switching position | | |
|-------------|--------------------|------|------|
| | | | |
| RS-6 | ON | none | ON |
| RS-6A | ON | OFF | ON |
| RS-6B | ON | None | (ON) |
| RS-6H | (ON) | OFF | (ON) |
| RS-6I | ON | OFF | (ON) |
| Term. Comm. | 2-3 | open | 2-1 |

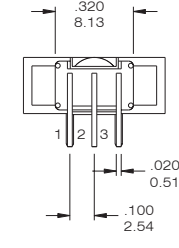
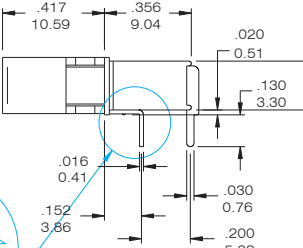
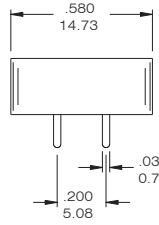

RS-6 - R2-2-Q / RS-6-R2-2-Q-S



DPDT



| Model No. | Switching position | | |
|-----------------------|--------------------|---------|---------|
| | | | |
| RS-7 | ON | none | ON |
| RS-7A | ON | OFF | ON |
| RS-7B | ON | None | (ON) |
| RS-7H | (ON) | OFF | (ON) |
| RS-7I | ON | OFF | (ON) |
| Term. Comm. | 2-3,5-6 | open | 2-1,5-4 |
| 3 way switches (SP3T) | | | |
| RS-7C | ON | ON | ON |
| Term. Comm. | 2-3,5-6 | 2-3,5-4 | 2-1,5-4 |

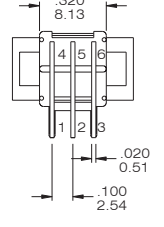
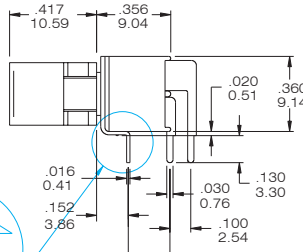
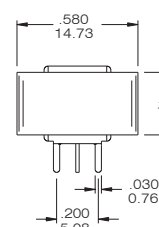

RS-7 - R1-2-Q / RS-7-R1-2-Q-S



SPDT



| Model No. | Switching position | | |
|-------------|--------------------|------|------|
| | | | |
| RS-8 | ON | none | ON |
| RS-8A | ON | OFF | ON |
| RS-8B | ON | None | (ON) |
| RS-8H | (ON) | OFF | (ON) |
| RS-8I | ON | OFF | (ON) |
| Term. Comm. | 2-3 | open | 2-1 |

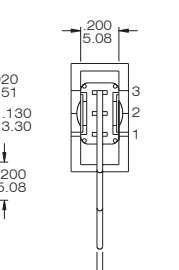
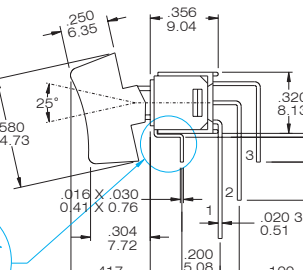
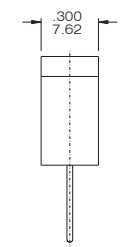

RS-8 - R1-2-Q / RS-8-R1-2-Q-S



DPDT



| Model No. | Switching position | | |
|-----------------------|--------------------|---------|---------|
| | | | |
| RS-9 | ON | none | ON |
| RS-9A | ON | OFF | ON |
| RS-9B | ON | None | (ON) |
| RS-9H | (ON) | OFF | (ON) |
| RS-9I | ON | OFF | (ON) |
| Term. Comm. | 2-3,5-6 | open | 2-1,5-4 |
| 3 way switches (SP3T) | | | |
| RS-9C | ON | ON | ON |
| Term. Comm. | 2-3,5-6 | 2-3,5-4 | 2-1,5-4 |

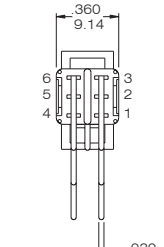
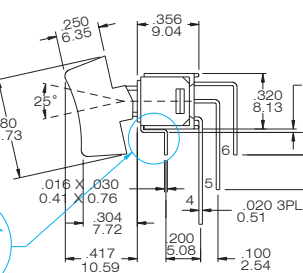
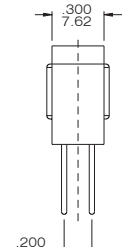

RS-9 - R1-2-Q / RS-9-R1-2-Q-S



INDEX

TOGGLE

ROCKER

SLIDE

PUSH BUTTON

DIP

TACT



Actuator Option

Actuator Color Option

R1

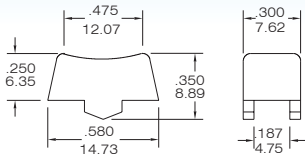

R2

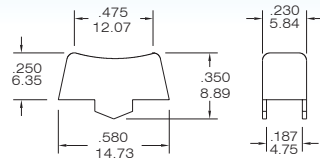

R3

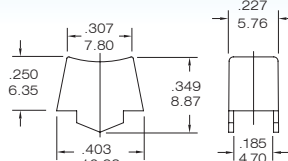

| Code | Color |
|------|-------------|
| 1 | White |
| 2 | Black(std.) |
| 3 | Red |

Other colors, customized actuator marking available consult factory.

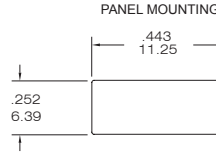
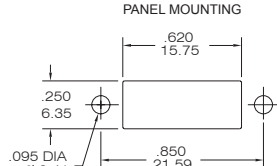
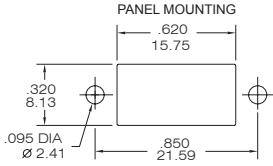

TERMINAL OPTION (ONLY FOR THE RS-4/RS-5)

B Solder Lug(STD)

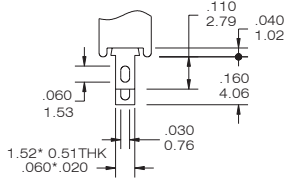

C PRINTED CIRCUIT

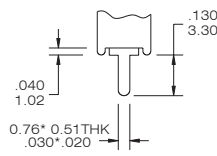

D Wire Wrap

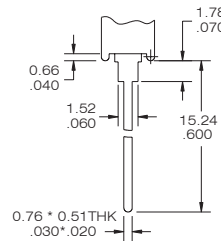

DPDT

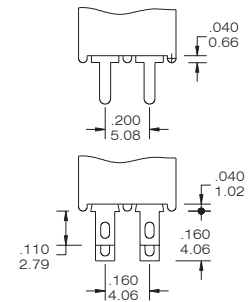

CONTACT MATERIAL OPTIONS

| CODE | CONTACT MATERIAL | TERMINAL MATERIAL | RATING |
|------|--------------------------------|--------------------------------|---|
| Q | Silver plated | Silver plated | 3 A @ 120V AC or 28 V DC; 1.5 A @ 250 VAC |
| R | Gold plated over nickel plated | Gold plated over nickel plated | 0.4VA MAX @ 20 V AC or DC MAX |
| G | Gold plated over silver plated | Gold plated over silver plated | 0.4 VA MAX @ 20 V AC or DC MAX or 3 A @ 120V AC or 28 V DC; 1.5 A @ 250 VAC |
| K | Gold plated over nickel plated | Tin over nickel plated | 0.4VA MAX @ 20 V AC or DC MAX |

* THE K option is only for some special item. Please inquire first when you need the "K" option

P.C.B MOUNTING DIMENSION

RS-4 (PC terminal)

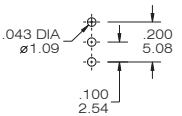

RS-6

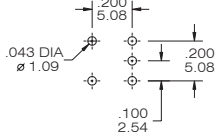

RS-8

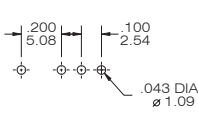

RS-5 (PC terminal)

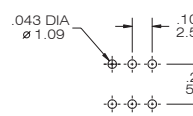

RS-7

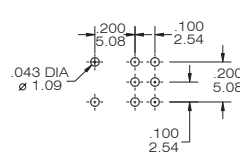

RS-9

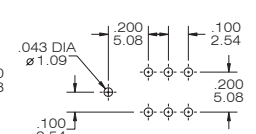

VERTICAL SUPPORT BRACKET OPTION

only for the RS-4/RS-5 . If you need the vertical support bracket , please build the terminal option is "C" code

A5/ A5S

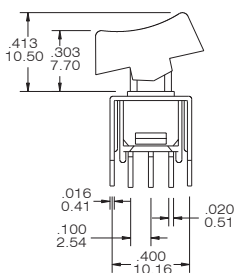
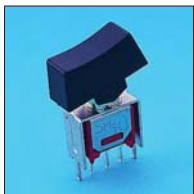

A5 (STD.)

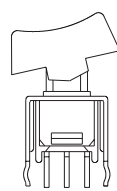

A5S (Snap-in)

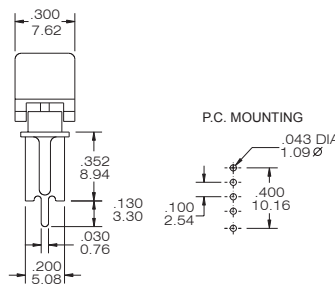

RS-4-R1-2-CQ-A5

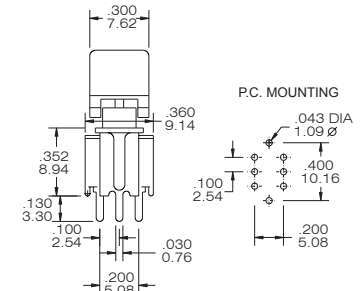

RS-5-R1-2-CQ-A5